

Transport Nagar Yojana



The proposed project is to reduce city congestion by providing transporters with a planned campus with a truck and logistics-friendly commercial plots and all necessities required for the new settlement.



TRANSPORT NAGAR MASTER PLAN
LAND AREA OF V.D.A (ACQUIRED ON SITE)

- COMPONENTS OF MASTER PLAN**
- ROADS - 24M WIDE MAIN ROAD
 - 18M WIDE ARTERIAL ROAD
 - 12M WIDE COLLECTOR ROAD
 - ISBT - 34350 SQ.M = 8.48 ACER
 - SHOPPING MALL AND HOTEL - 5681.7 SQ.M = 1.40 ACER
 - FUEL STATION - 1800 SQ.M
 - POWER STATION - 2276 SQ.M
 - POLICE STATION - 1084 SQ.M
 - WEIGH BRIDGE - 6 BAY
 - DISPENSARY - 600 SQ.M
 - HIGH DENSITY HIGH RISE GROUP HOUSING - 10% = 4.721 HACTARE
47213 SQ.M
 - GREEN AREA = 10% = 47213 SQ.M
 - T.T = TRANSPORT RELATED ACTIVITY =
- COLD STORAGES
 - CNF / AGENCIES
 - GODOWNS
 - COMMERCIAL OFFICES
 - SERVICE CENTER
 - MOTER GARAGE
 - RETAIL SHOPS
 - OFFICES
 - BANKS
 - POST OFFICE
 - COMMUNITY HALL
 - RESTAURANTS
 - GUEST HOUSES

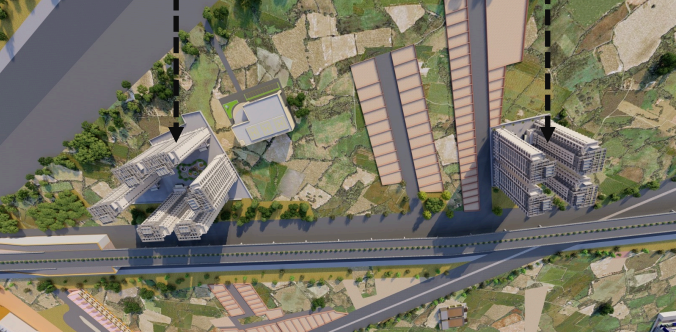
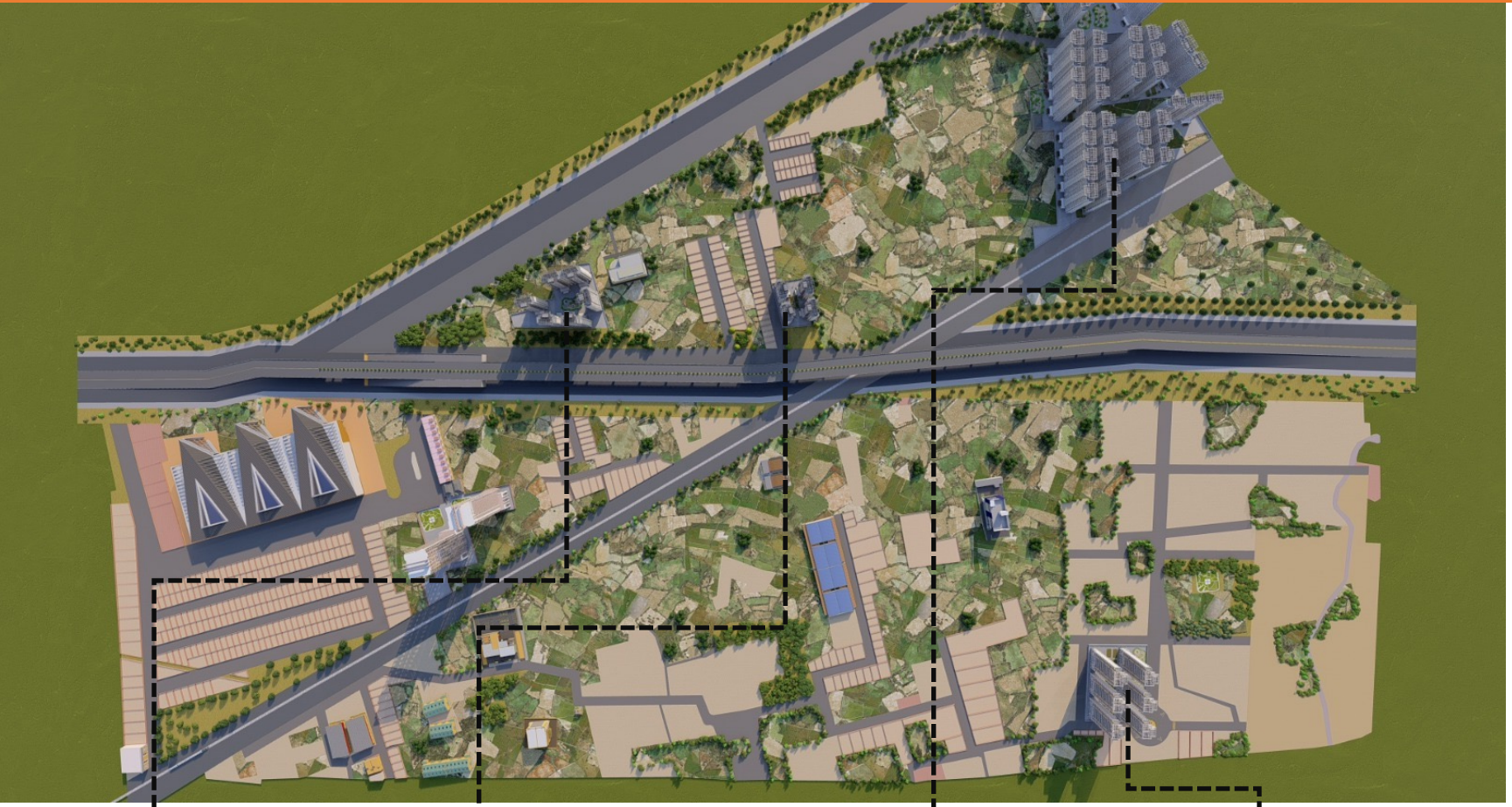

SITE PLAN



DESIGN - ROAD NETWORK

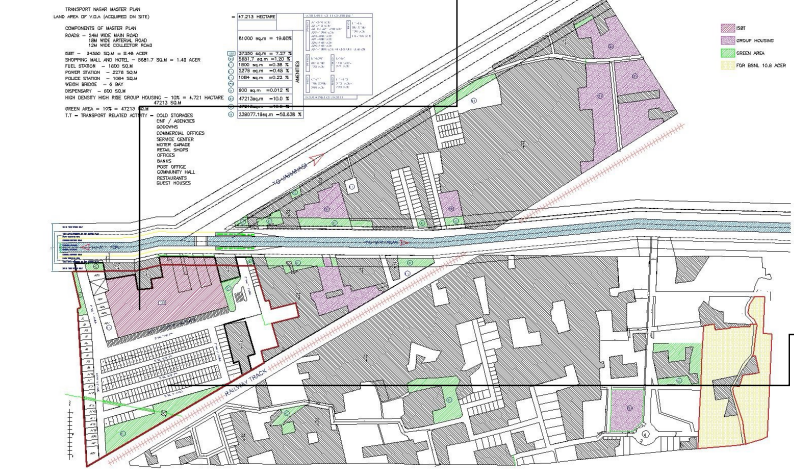
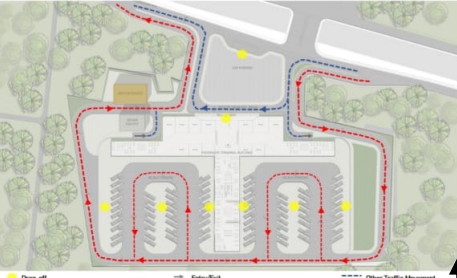

ISBT
IMS, VARANASI



COMMERCIAL PLOTS PHASE 1



FUEL STATION



1 HECTARE PATCH FOR LOGISTICS

THIS IRREGULAR LAND PATCH APART FROM TRUCKS MOVEMENT IS DEFINED FOR AFFORDABLE GROUP HOUSING

